

Farm safety: improving visibility of Stobie poles

Stobie poles and the powerlines they support can be a significant hazard on South Australia's rural properties.

On average there are more than 20 incidents each year where farm machinery hits Stobie poles and powerlines, resulting in a power outage, and damage to both the SA Power Networks asset and the farming equipment. These incidents also pose a high safety risk to people and property.

Reflective markers in the form of yellow corner cube delineators can be installed on Stobie poles to improve their visibility and reduce the likelihood of incidents involving farm equipment.

Installation

Installation of reflectors must adhere to the following guidelines:

Reflectors must be positioned at a maximum height of 3 metres above ground level.

Reflectors must not be placed on top of any existing signage.

Reflectors must not interfere with the operation of any asset/control box.

Reflectors should be installed on the side/s of the pole that will result in the greatest visibility.

Reflectors should be installed using a suitable adhesive (eg silicon). Power tools such as drills must not be used to install reflectors.

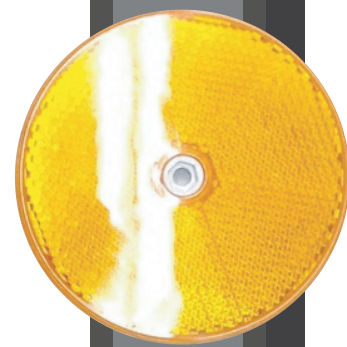

83mm
diameter

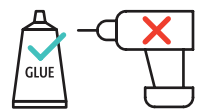

3m

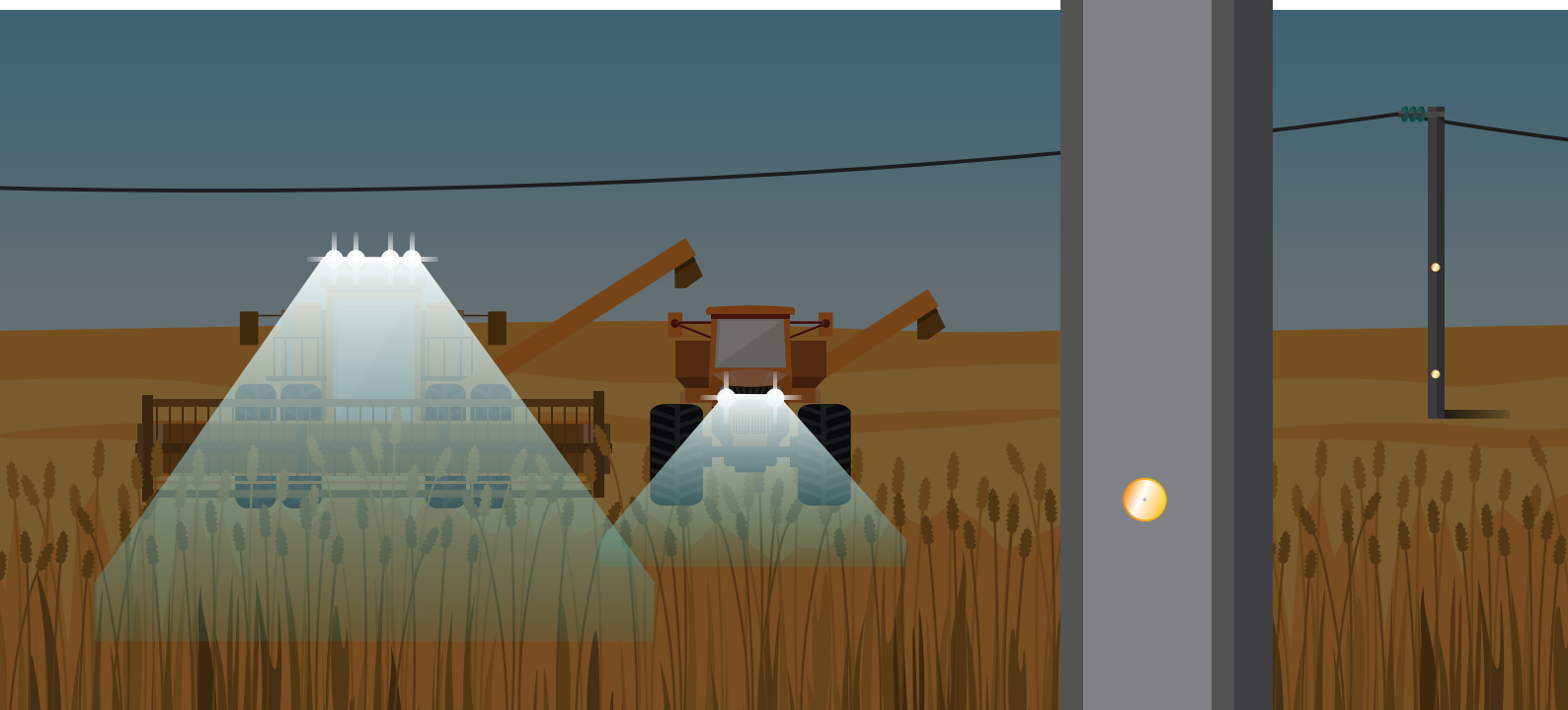

FAQs

Reflective markers on poles

Why should I put reflectors on the poles on my property?

Stobie poles and the powerlines they support can be a significant hazard on South Australia's rural properties.

On average there are more than 20 incidents each year where farm machinery hit Stobie poles and powerlines, resulting in a power outage, damage to both the SA Power Networks asset and the farming equipment, and posing a high safety risk to people and property.

The concept of a reflector is based on feedback from landowners and the desire to develop a simple solution to increase farmer safety near our infrastructure.

Where can I get reflectors?

Reflectors can be obtained by phoning SA Power Networks on **13 12 61**.

Can I use my own reflectors?

You can use your own reflector providing it is an 83mm diameter, yellow, corner cube reflector.

Can I put more than one reflector on a pole?

Yes, the more reflectors that are installed, the better the reflection and visibility will be. Consider placing reflectors on opposite sides of the pole if required.

How should I attach them?

Installation of reflectors must adhere to the following guidelines:

- Reflectors must be positioned at a maximum height of 3 metres above ground level.
- Reflectors must not be placed on top of any existing signage.
- Reflectors must not interfere with the operation of any asset/control box. SA Power Networks does not accept any liability for replacing the reflector on the pole when the pole is repaired or replaced in the normal course of network maintenance.
- The preferred method of installing the reflectors is to use a suitable adhesive, such as silicon, to stick the reflector to the Stobie pole. Power tools such as drills must not be used.

Why can't the reflector be placed higher than 3 metres above ground level?

Due to the variety of poles that are installed across the state,

SA Power Networks can't be sure exactly which pole the reflector will be placed onto. To ensure required powerline clearance distances are met, the maximum height they can be installed is 3 metres from ground level.



Visit lookupandlive.com.au to identify the location of powerlines on your property.

In a power emergency, call 13 13 66.
For police or ambulance assistance, call **000**.