

How do I switch from fixed to flexible export?

If you already have solar, are on a fixed export limit, and Flexible Exports is available in your area, you can submit an application to switch your export limit from fixed to flexible.

1. Click the “Apply” button on the dashboard, then select the size of the EG and click “Next”.

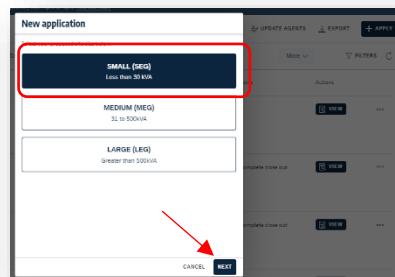
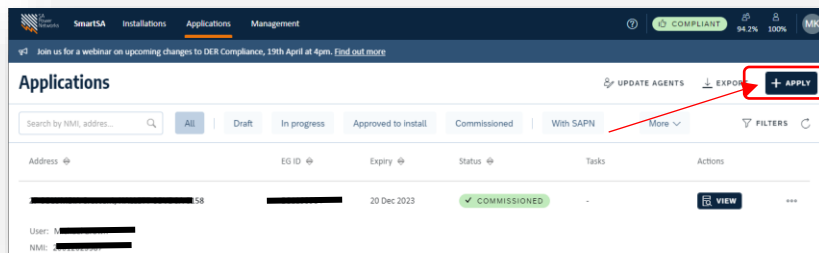

2. Enter the NMI and Meter number for the site, then click “Next”.

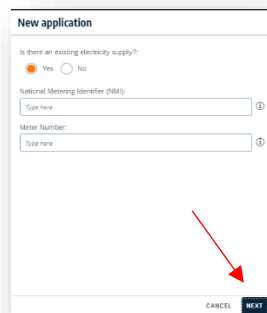

The address is displayed, along with a link to the user guides, click “Start” to continue.

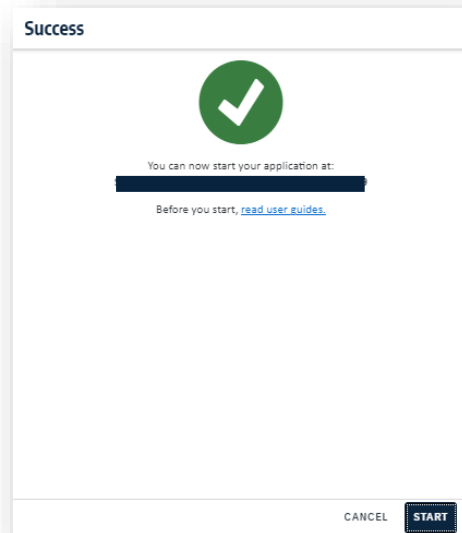

3. Location details are displayed, notice that you can suggest a change if the address is not showing correctly.

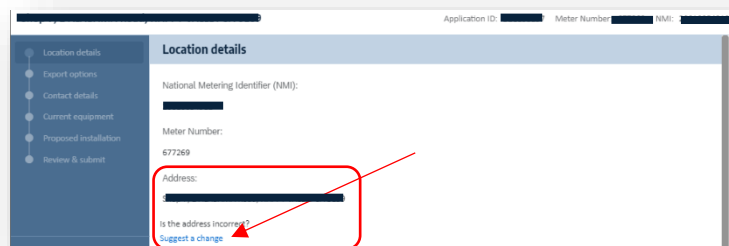

4. The export options available for the NMI are displayed. Click "next" to continue.

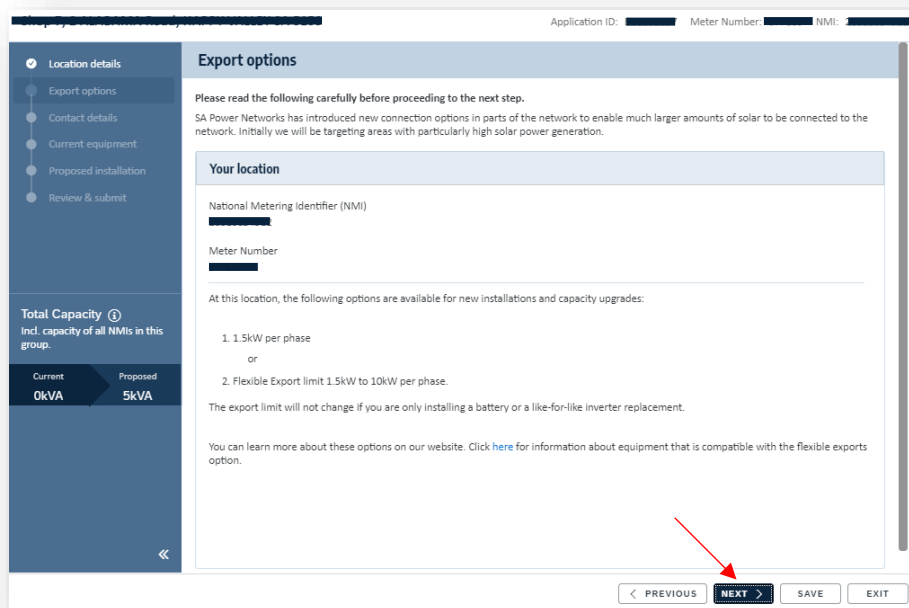

5. Enter the customer details. Click “next” to proceed.

6. Any existing equipment (either installed or approved) located at the site will be displayed. If the information is incorrect, click “No” to be able to edit the information. Note: if the application relates to a group of NMIs this information will be repeated for each NMI in the group or cluster. Then select the correct phasing for the site and click “Next”.

7. On the Proposed installation page, select the flexible option under export plan for the site.

8. You will be required to select a Flexible connection that will facilitate the ongoing Flexible Export system communications. Note that the connection must manage all inverters on the site.

FLEXIBLE CONNECTION

This site requires a flexible connection to facilitate the ongoing Flexible Export system communications. Please select the connection that will be used;

Select Flexible Connection...

Inverter Inbuilt

9. You will be required to select an export limiting device. The selection list will be filtered to only show devices compatible with your equipment.

EXPORT LIMITING DEVICE

The site requires an export limiting device to enable a flexible export limit. Please select the device that will be used;

Shenzhen Growatt New Energy Co Ltd

10. Click next.

Application ID: Meter Number: NMI:

NMI

Connection Type: Single Phase

SWER Line: NO

Export Plan: Flexible

Export Limit: 1.5-10 kW / phase

Device	Manufacturer	Model	Quantity	Capacity
PV Inverter	Fronius Austral...	Primo 4.6-1 (AS4777-2 2020)	1	4.6 kVA
PV Panels	Apex Solar Ene...	HRAP-110H-560M12	5	2.8 kW

+ ADD DEVICE *Relevant agent not required whilst enrolled in flexible exports.

+ ADD INVERTER

The selected setup is valid for auto-approval provided the components are installed to the phases in a way that does not cause an imbalance between phases greater than 5kVA or a phase total to exceed 10kVA. Please note that any legacy non-flexible PV must be export limited to zero.

PREVIOUS **NEXT** SAVE EXIT

11. The entire application is displayed. You can review, add supporting information. Agree to the terms displayed, and then click submit when ready.

Application ID: [REDACTED] Meter Number: [REDACTED] NMI: 0018854016

PV Panels Apex Solar Energy T... HRAP-110H-560M12 5 2.8 kW

*Relevant agent not required whilst enrolled in flexible exports.

EXPORT LIMITING DEVICE

The site requires an export limiting device to enable a flexible export limit. Please select the device that will be used;

Fronius Australia Pty Ltd - SwitchDin Droplet + Fronius Smart Meter 50KA-3

Comments (optional): 0/5000

- I have read and agree to the [Small embedded generators model standing offer terms and conditions for basic connection services](#).
- I have obtained all required consents, approvals and/or authorisation and acknowledge this approval is subject to the limitations of the premise internal network.
- I am aware of the commissioning requirements of my Flexible Exports compatible equipment which can be found [here](#).

< PREVIOUS **SUBMIT** > SAVE EXIT

12. The approved application will be displayed on your dashboard. An approval email will be sent to your email address and the customer address that you entered in step [5](#)