

How do I create a V2G application?

Before you install or upgrade [embedded generation or EV](#) equipment such as solar panels, battery storage or EV chargers, we'll need to assess the impact this equipment will have on our local network to ensure it does not negatively affect others.

Our Portal is used to gain approval to install this equipment. Installers and Electricians must commission and close out embedded generators and electric vehicle chargers in the Portal.

More guides can be found [here](#), including how to register for the Portal if you do not have an account.

The below instructions apply for Small Embedded Generation (SEG) sites (up to 30kVA of embedded generation).

1. Click the "Request" button on the dashboard, then select "Small (SEG)". You must raise the application and receive approval prior to installing any equipment.

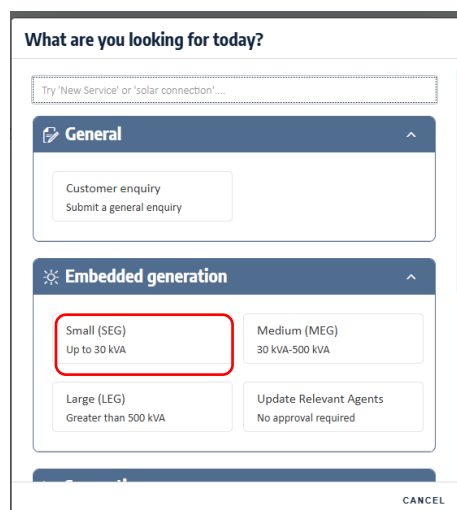
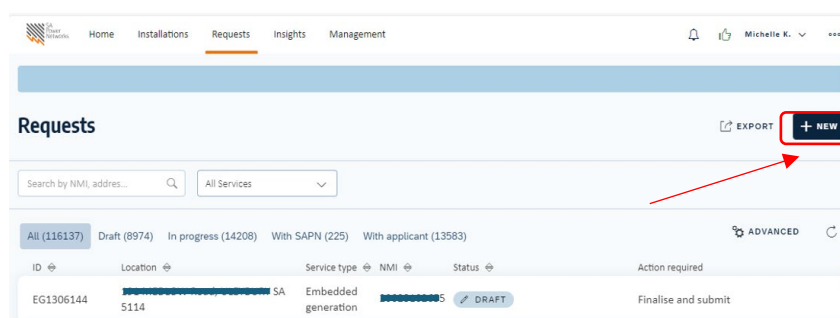

2. Enter the NMI and Meter number for the site where the charger will be installed, then click "Next".

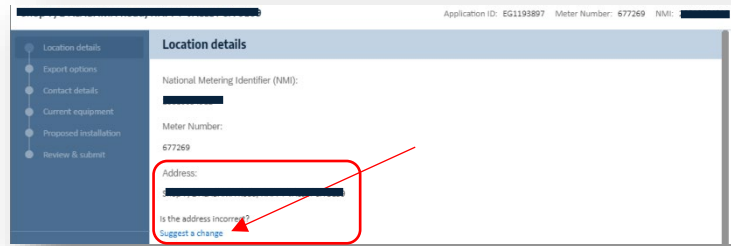

4. The export options available for the NMI are displayed. Click “next” to continue. The existing export limit will not change if you are only adding a battery (including V2G). Standalone V2G systems are not currently included in the [Flexible Exports offer](#).

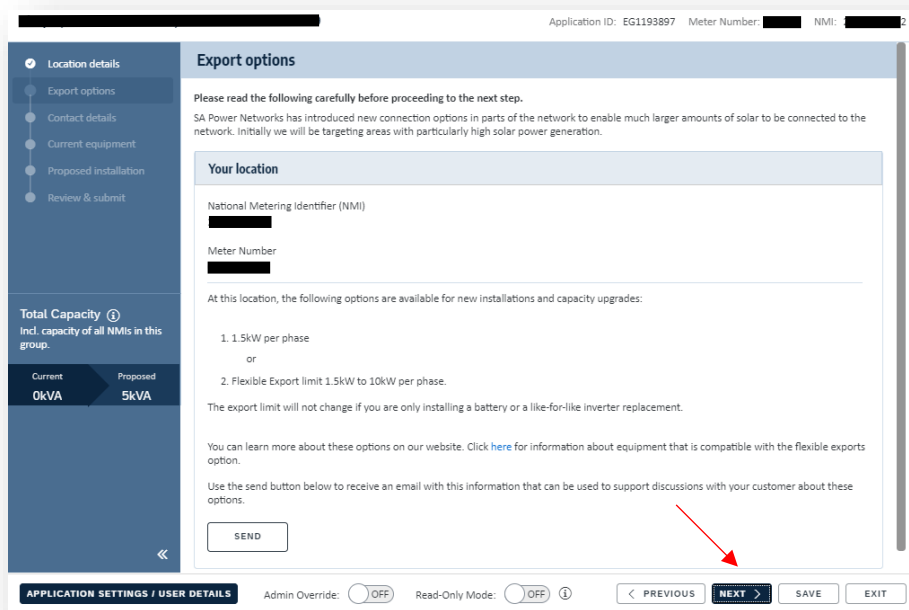

5. Enter the customer details and click “next” to proceed

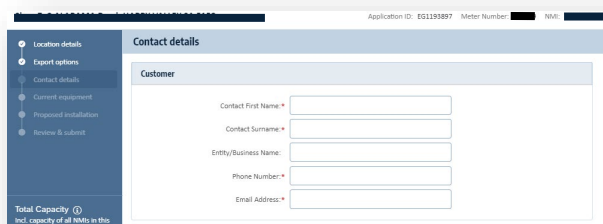

6. Any existing, installed equipment located at the site will be displayed. If the information is correct, you can simply proceed by clicking next. If it is incorrect, click “No” to be able to edit the information.

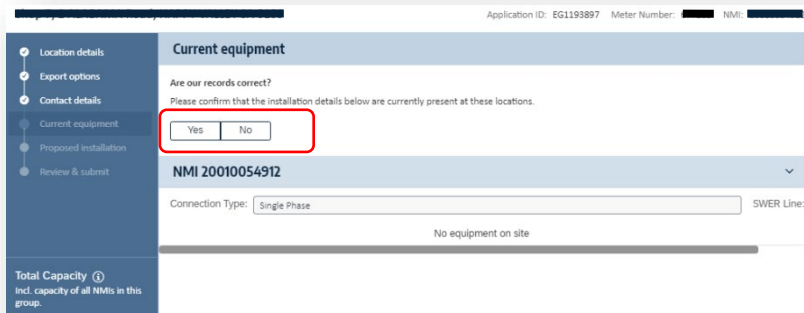

7. On the Proposed page you can add your equipment. Click “Add equipment” then do not select anything from the device drop-down list – leave it as ‘Inverter’. If you are only adding a V2G charger you can leave the export plan as it is. You do not need to change it to Flexible or Fixed if it is on a Legacy plan.

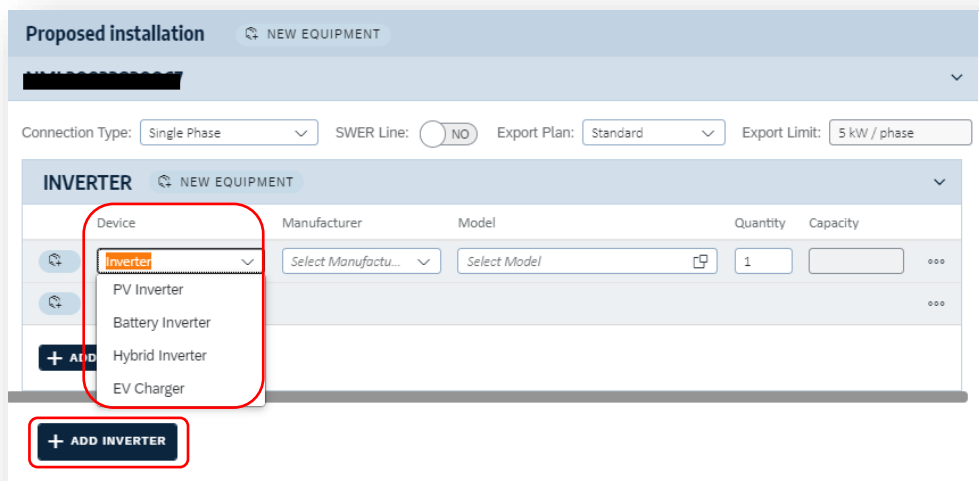

8. Leave the manufacturer field empty, then enter the model for the EV charger. If you need to **Generation Limit** the device to comply with SA Power Networks’ technical standards, make sure to select the mode with the corresponding capacity. If the relevant generation limited version of the device is not available as an option, please contact our Industry Inquiries Team via customerservice@sapowernetworks.com.au. See our V2G installer reference page for more details on inverter size allowances for V2G: <https://www.sapowernetworks.com.au/connections/connect-solar-and-ev-chargers/electric-vehicle-charger-installations/bidirectional-and-v2g-charging-on-the-network/>

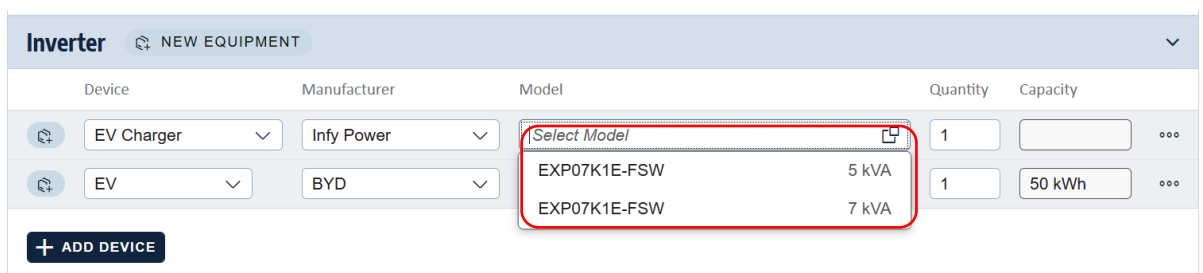

- List at least one EV as the device. You can have multiple EVs. Use the **+ ADD DEVICE** option to enter these, if you wish, but it is not mandatory to add any further vehicles after entering the primary vehicle. If the EV is not listed, you can select 'Generic Electric Vehicle'.
- Once you have entered the minimum required information a green banner message will let you know that the application is ready for auto approval. Click next to review your application.

Device	Manufacturer	Model	Quantity	Capacity
EV Charger	Infy Power	EXP07K1E-FSW	1	7 kVA
EV	BYD	Atto 3	1	50 kWh

The selected setup is valid for submission provided the components are installed to the service point phases in a way that does not cause an imbalance greater than 5kVA or a phase total to exceed 10kVA.

- The entire application is displayed. You can review, add supporting information. Agree to the terms displayed, and then click submit when ready.

Comments (optional): 0/5000

Export limiting device

Meter Isolator

In accordance with the Feed-in Tariff legislation set out under 3AB of the Electricity Act 1996 if an existing eligible generator is on or after 1 October 2011, altered in a manner that increases the capacity of the generator to generate electricity, is disconnected and moved to another site, or an energy storage device is installed the customer will no longer be eligible to receive the feed-in credits.

SA Power Networks will assume that the date of submission of this application is the date of the alteration or disconnection as stipulated in the Act and the payment of any applicable feed-in rebate credits will cease from this date.

If Premium Feed-in Tariff is applicable to the site, I have explained the above to the customer.

I have read and agree to the [Small embedded generators model standing offer terms and conditions for basic connection services](#).

12. If all requirements have been met, The application will be approved automatically and displayed on your dashboard. An approval email will be sent to your email address and the customer address that you entered in step [5](#). You can now install the equipment on site, and you must close out the equipment in Installations. Guides on how to do that can be found [here](#).